

Reading on city planning

- History of Tokyo
 - Relationship to the shogunate



- 20th century urban planning
 - Land “readjustment” as a way of gaining support for urban development

Example of a land readjustment project

Before land readjustment

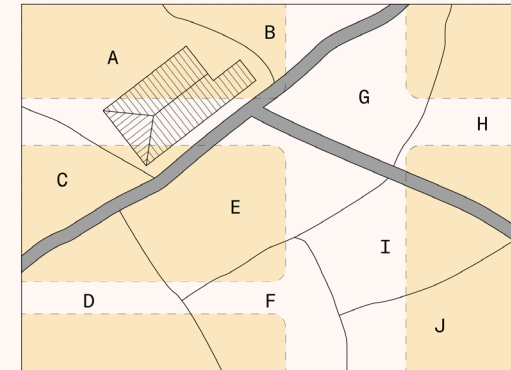

Replotting

After land readjustment

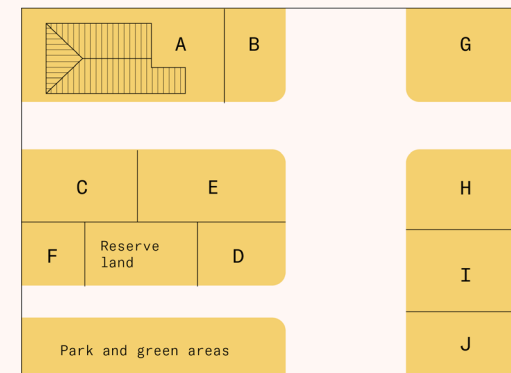

土地区画整理 *tochi kukaku seiri*

YOKOHAMA 横浜



Japan TREK 2026

A map of Japan with a dark grey text box overlaid on the left side. The text box contains text about Yokohama's transformation in the late 19th century. The map shows the main islands of Japan with several cities marked with blue squares and labeled: Aomori, Akita, Yamagata, Fukushima, Tokyo, Nagoya, Yokohama, Osaka, Fukuoka, and Matsuyama. The Pacific Ocean is labeled to the east, and North Korea and South Korea are partially visible to the west.

Yokohama's transformation in the late 19th c.

1900 - major port city of 200,000 / in 1850, small fishing village

How did this happen?



Background

Japan's foreign trade from
1630s to 1854

- Dutch and Chinese in
Nagasaki



DEJIMA (DUTCH QUARTER IN NAGASAKI)

Gunboat diplomacy

- 1853: US sails warships to Japan
- 1854 and 1858 Treaties
 - Yokohama becomes a 'treaty port'





"COMPLETE
DETAILED VIEW
OF YOKOHAMA"

SADAHIDE, 1860

圖見粵港并本橫
全細崎 = 粵濱

YOKOHAMA
BECAME
INTERWOVEN
WITH THE
GLOBE



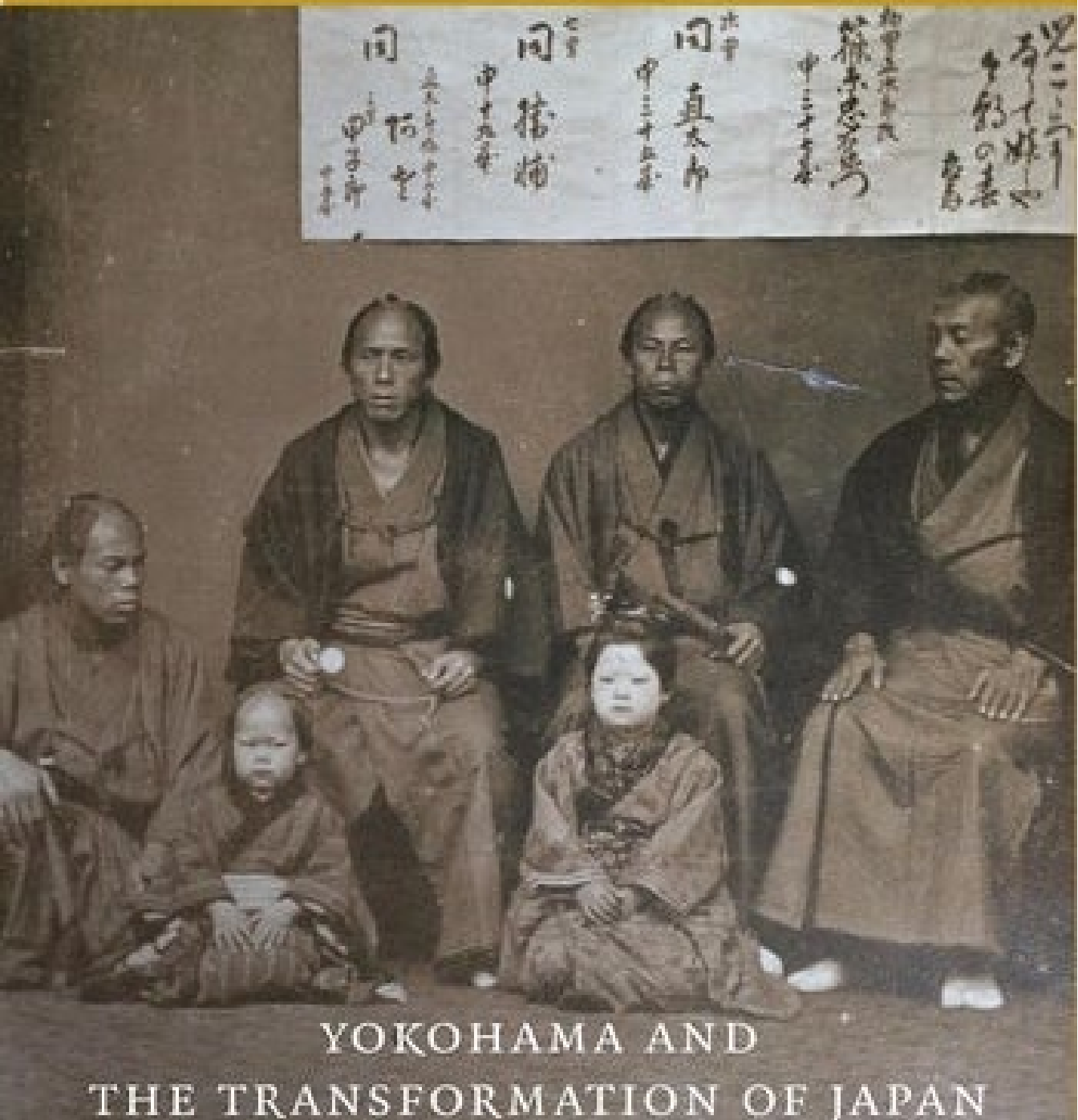

Shinohara Chūemon & Global economy

- Selling tabi socks
- 1860s - US Civil War (Cotton), Taiping, and silkworm blights (rise of Silk exports)
- 1870 - Siege of Paris (Franco-Prussian War)
- Japanese silk trade shifts to US





IMPORT SUBSTITUTION (1700S) AS FOUNDATION FOR THE MODERN SILK INDUSTRY

(PHOTO DATED 1904 ... ABOUT 9 MILL KG OF SILK EXPORTED)



Exporting "Japan"

- Yokohama exported Japanese objects that reinforced (enduring) Western visions of Japanese culture
- [Exporting Beauty – Google Arts & Culture](#) (Yokohama's role in exporting 'Japanese' gardens)

The
Yokohama Nursery Co., Ltd.

THE
Yokohama,
Nursery,
Co., Ltd.
Nos. 21-35,
Nakamura,
YOKOHAMA,
JAPAN.

1901

JAPANESE
GARDEN, BARROW
HILLS, SURREY
1920/1921





YOKOHAMA SHASHIN AS A SOURCE ON JAPAN
(PAINTING BY E.A. HORNEL)

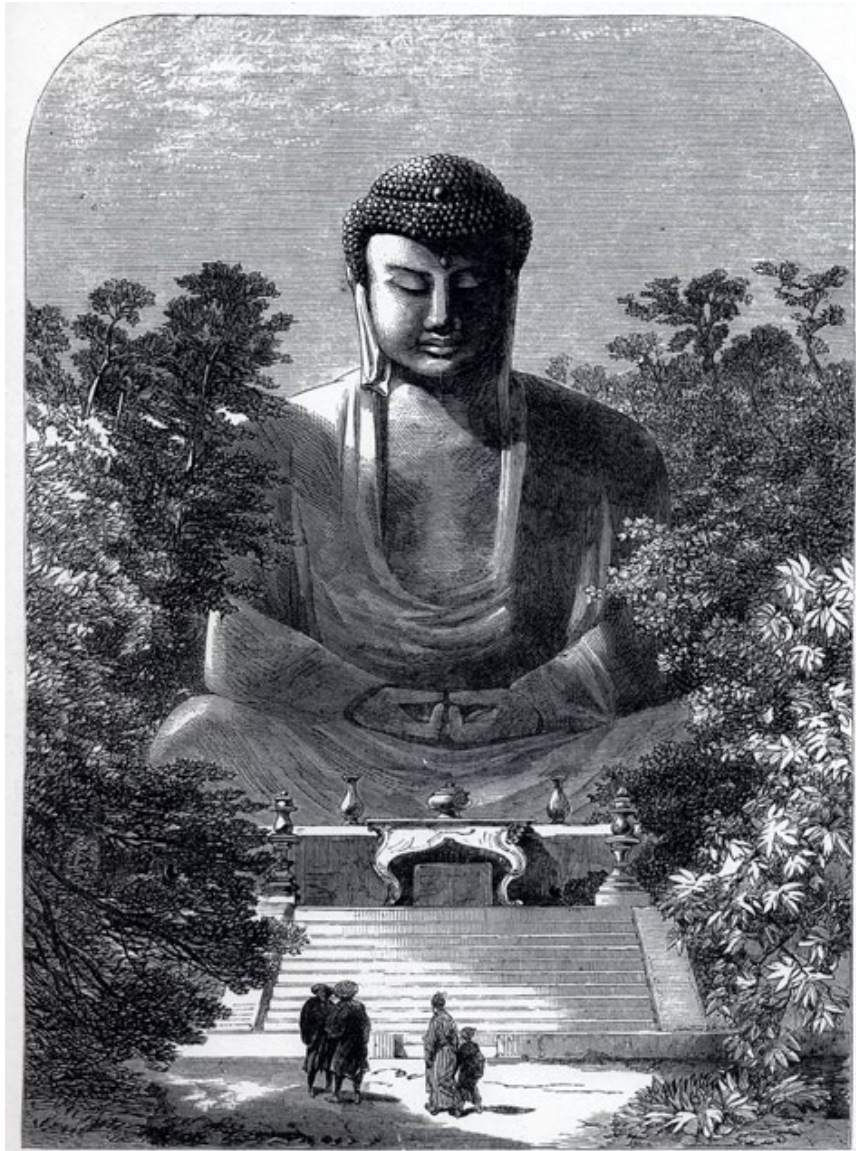

THE DAIBODHI, OR COLOSSAL BRONZE IMAGE OF A BUDDHIST IDOL, IN THE TEMPLE OF KAMAKURA, JAPAN.



SKETCHES FROM JAPAN, BY OUR SPECIAL ARTIST: THE CUSTOM-HOUSE AT YOKUHAMA.

London Daily News

- Images of “quintessential Japan”, but also Japan as a proto-capitalist society, eager to adopt western ways ...



Cholera in Japan

- 1858 - 200,000 deaths
- 1879 - 100,000 deaths
- After 1870s, cholera was endemic, but often blamed on foreigners - especially Chinese in **treaty ports**
- A form of racist **biopolitics** would come to shape Japanese approaches to empire building (Rogaski)

For tomorrow

What are some ways that this history of interaction with the globe has shaped Yokohama today?

We'll be visiting Chinatown, the port, and a small museum on Yokohama history.